

## LGB Series 2 Pilot and Flame Sensor

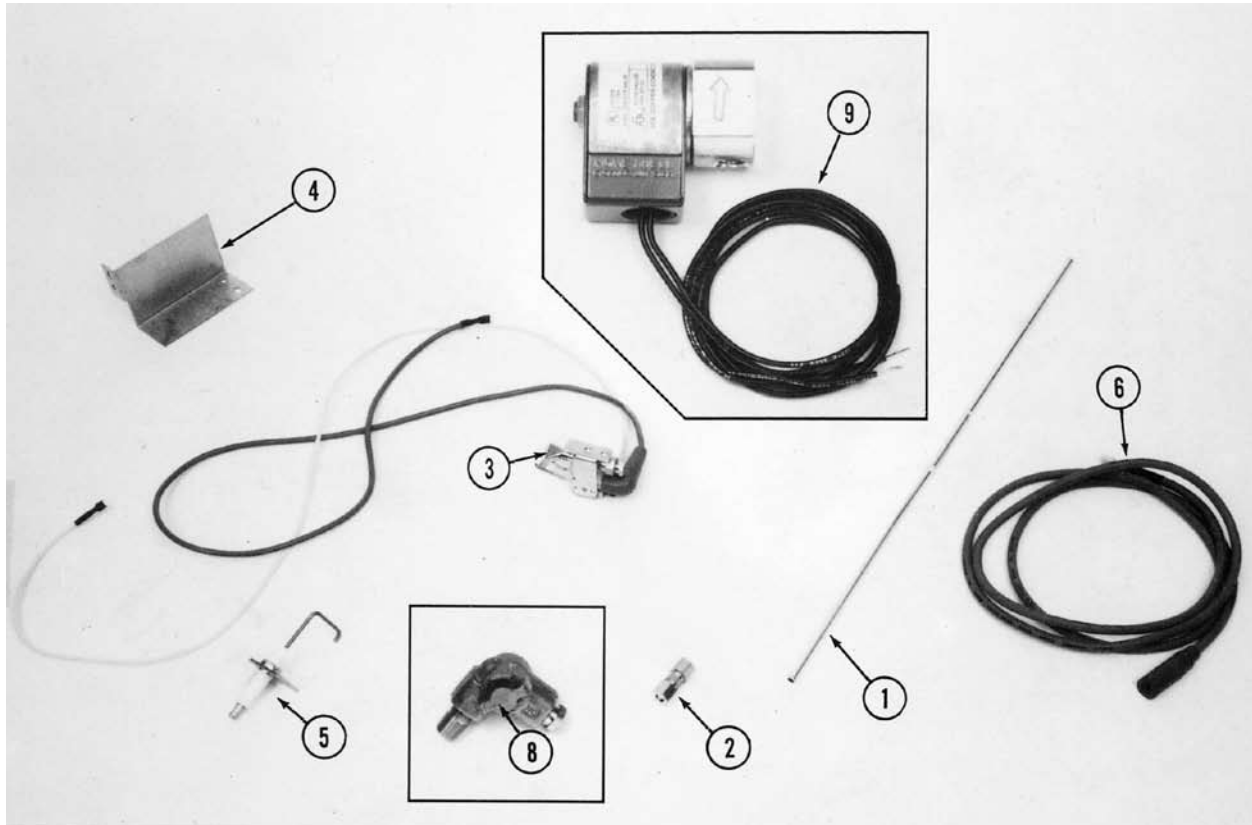

Fig. No.	Part No.	Description	Mfr.	Mfr.'s Part No.	4-5	6-12	13-23
<b>LGB Pilots and Flame Sensor</b>							
1	560-742-880	Pilot Line Aluminum Tubing, 2 pieces required, 1/4" Dia. X 20" Long	Weil-McLain			1	2
2	561-643-450	Pilot Line Union, 1/4" CC	Weil-McLain			1	2
3N	511-330-221	NG PIN Pilot Burner Assembly with pilot burner, orifice, sensing lead and ignition cable	PSE	PSE-NA16	1	1	2
4	460-005-624	Combination Pilot Burner Mounting Bracket	Weil-McLain			1	2
5	511-724-274	Main Flame Sensor	Honeywell	MH 392956		1	2
6	591-391-790	Sensing Cable for Main Flame Sensor, 72" Long	Ristance	180749		1	2
7	423-300-420	Main Flame Sensor Mounting Bracket	Weil-McLain			1	2
8	511-246-340	Manual Shut-Off Pilot Gas Valve, 1/8" N.P.T. X 1/4" CC	Conbraco	56-603-01		1	2
			Key	P2R			
9	511-044-039	Pilot Line Solenoid Gas Valve, 1/4" N.P.T., 24 Volt	Honeywell	V8046C1014		1	2
			Johnson Controls	H91ABG-5C			
NS	511-044-287	Gas Valve, 1" N.P.T., Robertshaw 7000DERHC-S7C	Grayson	5N6-501-723	1		