

Pilot Burners

Q314 Pilot Burner



Nonprimary-aerated, insert orifice type pilot burner for main burner ignition with Q340 or Q390 Thermocouple for Pilotstat safety control operation.

- Use with Q313 Thermopile Generator for 750 mV powerpile applications.
- Variety of mounting brackets available.
- Variety of tip styles to provide desired flame pattern.
- Interchangeable, color-coded orifice and inlet fittings can be ordered to convert between natural and LP gas.
- Single tip style.

Dimensions in inches (millimeters)

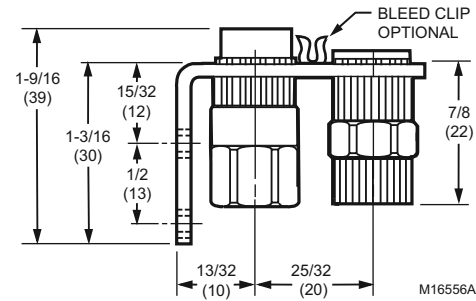
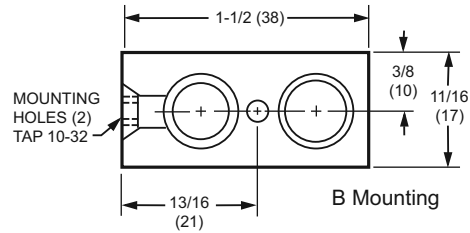
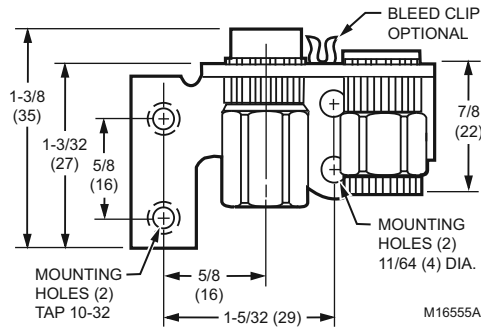
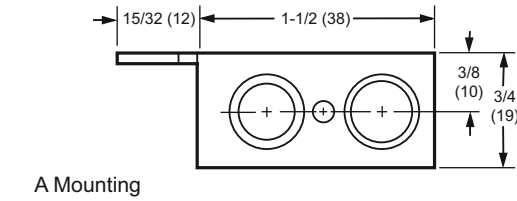

Type of Gas: Natural
Aeration: Non-primary

Approvals:
American Gas Association: —
IAS Certified File No. L2025001

Product Number	Compression Fitting Size	Mounting Bracket	Direction of Front Tip	Orifice	Includes
Q314A3513	1/4 in.	A	(F) Front	BCR-18 (0.018 in.)	—
Q314A3547	1/4 in.	A	(L) Left	BCR-18 (0.018 in.)	—
• Q314A4586	1/4 in.	B	(F) Front	BBR-10 (0.010 in.)BCR-18 (0.018 in.)	Special mounting bracket with screws to convert "B" bracket to "A" bracket.
* Q314A6094	1/4 in.	B	(L) Left	BBR-10 (0.010 in.)BCR-18 (0.018 in.)	Special mounting bracket with screws to convert "B" bracket to "A" bracket.
* Q314A6102	1/4 in.	B	(K) Right	BBR-10 (0.010 in.)BCR-18 (0.018 in.)	Special mounting bracket with screws to convert "B" bracket to "A" bracket.

* TRADELINE models • SUPER TRADELINE models